

12030832 Song Series

Wireless Switch, PIR+Touch, Monochrome

R1

# Technical Datasheet

Ariginal Product

# Table of Contents

I. Products Overview .....	2
II. Product Code .....	3
III. Features .....	4
IV. Dimensions & Structures .....	8
V. Specifications .....	9
VI. Installation .....	10
VII. Usage .....	11

## I. Products Overview

### What is an Ariginal Wireless Switch?

The Ariginal Wireless Switch is a cutting-edge, multifunctional control device designed to offer seamless operation of lighting systems without the need for physical wiring.

This versatile switch is available in various versions, including IR (hand swipe), PIR (motion sensing), door-sensing, and touch control, providing tailored solutions to suit different needs. Whether you're operating lights via a simple hand gesture, detecting motion, or triggering the switch by opening or closing doors, the Ariginal Wireless Switch offers flexibility and ease of use.

With its sleek design and compatibility with both monochrome and tunable white lighting systems, it integrates effortlessly into any setup, Ideal for residential and commercial environments.

### What is an Ariginal PIR Wireless Switch?

The Ariginal PIR Wireless Switch is a **2-in-1** sensor switch that integrate motion sensing and touch sensing in one device, and automatically turns lights on when people get close and turns them off when they walk away, it can also adjust the brightness the LED lights by holding finger on the touch area for 2 seconds. It uses Passive Infrared (PIR) sensor technology to detect movement, and uses electrostatic field technology to detect touch action, and works wirelessly with Ariginal Wireless Receivers.

This makes it perfect for hands-free lighting in places like cabinets, closets, hallways, or any area where you need automatic on/off control without touching a switch.

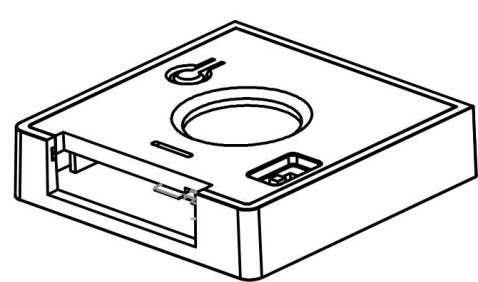

### Applications:

It's mainly installed in cabinets, recessed in the wood panel, or surface-mounted in a open area.

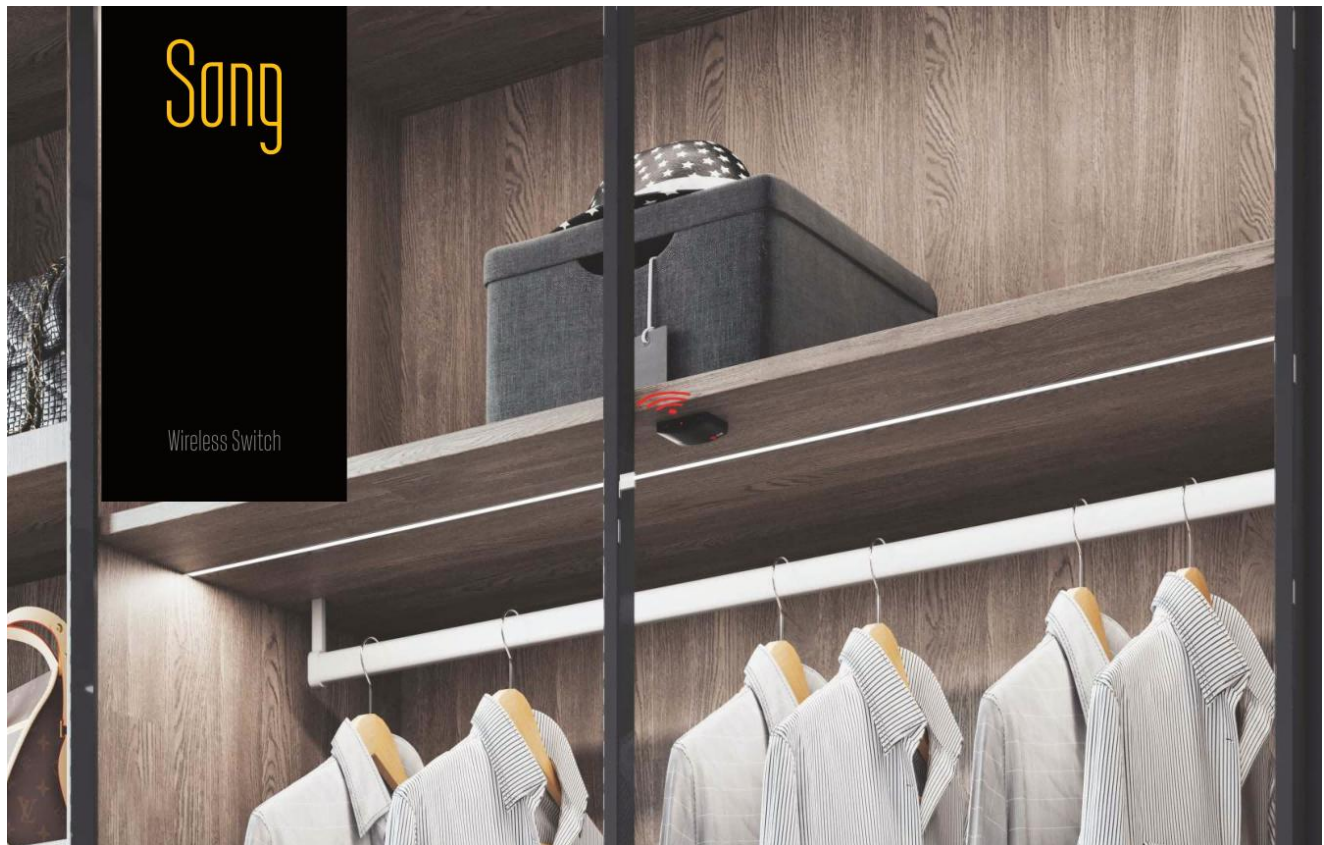

## II. Product Code

The descriptions in this document are applicable to the following products only:

Original Monochrome Wireless Receiver.

Item Code	Input Voltage	Battery	Control Method	Dimension
12030832	3VDC	CR2450	Touch + PIR	49.5*46.7*12.8mm

### III. Features

The Ariginal "Song" series wireless switch provides maximum flexibility in installation, operation, and maintenance. The PIR sensor switch is especially smart and convenient—there's no need to touch or control it manually. It automatically turns the lights on when it detects movement and off when no motion is detected, making lighting effortless and hands-free.

It's the wireless switch that's born for freedom.

Its main features include:

#### ❶ Free installation.

Recess or surface-mounted installation, it's up to you.



"Song" series wireless switch offers free Installation, providing total flexibility in how it's installed. Whether you choose a recessed option for a sleek, flush appearance or a surface-mounted setup for quick and simple fitting, the decision is yours.

This versatile design eliminates complex wiring or mounting limitations, allowing the switch to blend effortlessly into any environment while ensuring a functional, personalized scenario.

#### ❷ Free placement.

One light can be controlled from multiple switches located anywhere.

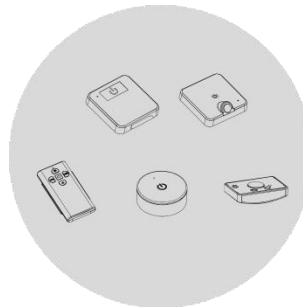

"Song" provides the freedom to control your lights from anywhere, delivering convenience and ease like never before. Imagine turning on the kitchen lights from your living room or adjusting the bedroom lights from your bedside—this system allows you to place up to eight switches for a single light in the most convenient spots for your daily routine. Whether you're entering from different rooms or simply want easy access from various locations, you'll have full control.

Additionally, this freedom eliminates the need to walk across the room or house to find a light switch, making it perfect for large spaces, multi-room setups, or even hard-to-reach areas. With the ability for each switch to control unlimited LED lights, the Song series empowers you to customize your lighting experience to fit your lifestyle, ensuring convenience, comfort, and flexibility at every turn.

### ③ Free pairing.

Power-cut pairing is now upgraded to press-to-pair.

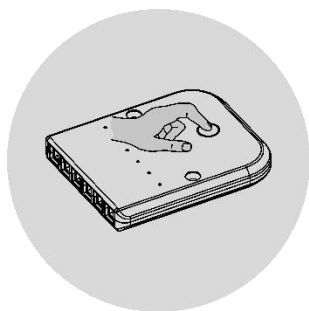

"Song" has been upgraded with a more convenient Press-to-Pair feature, replacing the old power-cut pairing method. Previously, users had to unplug the device and reconnect the power to activate pairing. Now, with just a simple press of a button, pairing is instantly initiated, making the process faster, easier, and more user-friendly. This upgrade reflects our commitment to providing effortless control and a intuitive experience for your lighting system.

### ④ Free control method.

IR / IR Door / PIR / Touch, several control methods to cover all your needs.

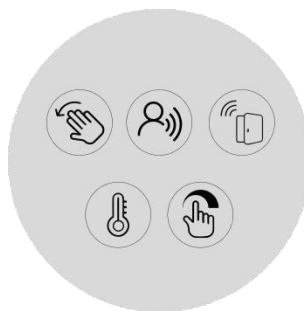

"Song" offers versatile control options, including IR, IR Door, PIR, and Touch, to cater to all your lighting needs. With the IR feature, users can simply swipe their hand over the IR detector to turn lights on or off, or hold their hand to dim the lights, providing an intuitive and modern interaction to your lighting control.

The IR Door feature is perfect for cabinet lighting, automatically turning lights on when the door is opened and off when it's closed, adding convenience to your daily routines. The PIR motion sensing capability allows lights to activate when movement is detected, making it ideal for hallways, staircases, or entryways where hands-free operation is essential. Lastly, the Touch option offers direct control for users who prefer a tactile interface. With these diverse control methods, the Song series ensures that you can adapt your lighting setup to suit various scenarios in your home, enhancing both functionality and convenience.

### ⑤ 2-in-1 Smart interaction.

Turn the lights on and off, the switch does the job automatically.

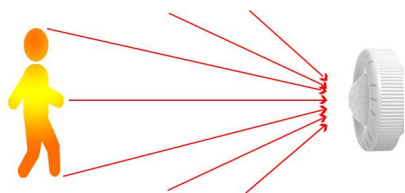

The Original PIR Wireless Switch takes lighting control to the next level—no touch, no hassle. It automatically turns the lights on when you approach and switches them off when you leave, providing a seamless, hands-free experience. Perfect for cabinets, wardrobes, hallways, and other spaces where convenience and efficiency matter.

But to Ariginal Song series PIR wireless switch, it's also integrated with touch sensor, to allow you to adjust the brightness of LED lights.

### ⑦ Compact design.

Switch is just a switch, sometimes we need it to be invisible.



Sometimes, a switch is just a switch, and in certain scenarios, we need it to be invisible. The "Song" series features an IR door switch that can be elegantly recessed into a wood panel, achieving a seamless and unobtrusive design. Its compact size ensures it doesn't disrupt the aesthetic of your space, providing essential functionality without drawing attention.

This thoughtful design choice makes it perfect for modern interiors, where maintaining a clean, minimalist look is essential while still offering precise access to lighting control.

### ⑥ 10 meter control distance..

Why should you walk? Why not put the switch right next to you?

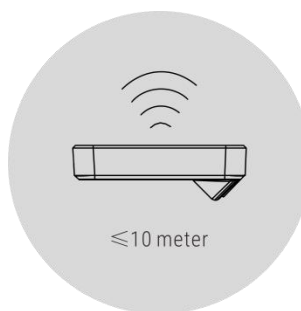

How big is your room? "Song" offers an impressive control distance of up to 10 meters, ensuring that you can operate your lights from virtually anywhere in your space. Whether you're relaxing on the couch or moving around the room, this extended range provides the freedom to control your lighting without limitations.

Enjoy arbitrary access to your lights, enhancing convenience and comfort in any area of your home, regardless of size.

### ⑧ Magnetic attachment.

A belt-and-braces approach, to make sure the switch is fastened.

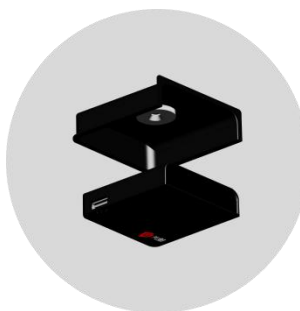

The Song series wireless switch incorporates a magnetic attachment system, providing an added layer of security alongside its clip holder. This dual fastening method ensures the switch remains firmly in place, preventing it from falling off even when installed underneath a panel.

### ⑨ Free battery changing.

CR2450 lithium battery is included in the package, it's replaceable.



"Song" comes with a CR2450 lithium battery included in the package, ensuring you have everything you need for immediate use. This user-friendly design allows for easy battery replacement, enabling you to maintain optimal performance without hassle.

Simply swap out the battery when needed, and enjoy uninterrupted control of your lighting.

### ⑩ Globally certified.

It's fully certified for sale across five continents.

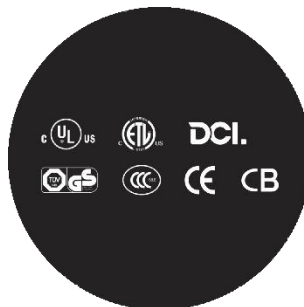

"Song" is globally certified, ensuring it meets stringent safety and quality standards for sale across five continents. This certification not only reflects the product's reliability and performance but also provides peace of mind for users worldwide.

With its international recognition, you can confidently integrate the Song series into your lighting systems, knowing it adheres to the highest standards of excellence, making it a trusted choice for any space, no matter where you are.

IV. Dimensions & Structures

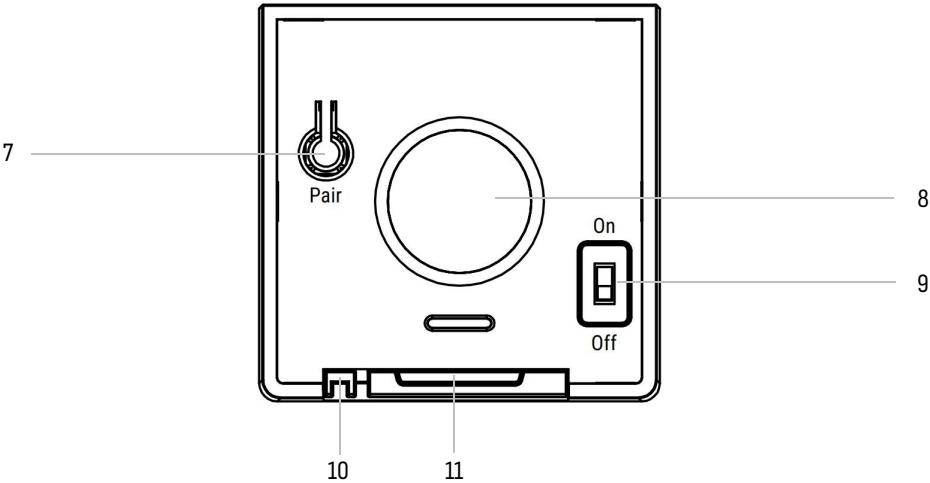
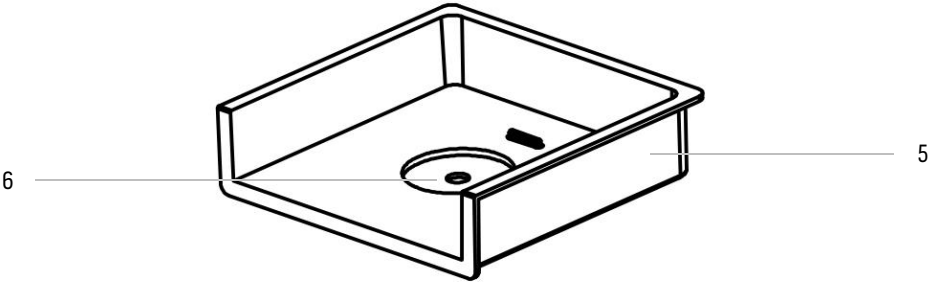
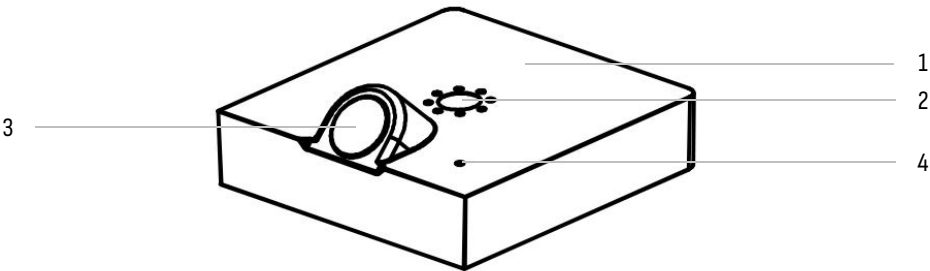
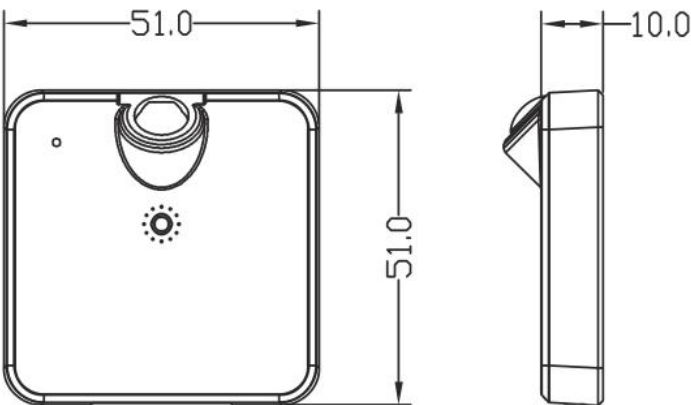

Back view of the product



No.	Picture	Structure name
1	See above	Product body
2	See above	Touch icon / touch area
3	See above	PIR detector
4	See above	Indicator light
5	See above	Product holder (installation holder)
6	See above	A hole for magnet
7	See above	Paring button
8	See above	A hole for magnet
9	See above	Toggle switch to turn on/off the Wireless Switch
10	See above	Clip of the battery door
11	See above	Battery door

## V. Specifications

Parameter	Value
Input voltage:	3VDC
Powered by	CR2450 battery
Frequency band:	2.400–2.4835 GHz (ISM)
Functions:	2-in-1: PIR sensor automatically turns the lights on when people approach and switches them off when they leave; Touch sensor allows users to adjust the brightness of LED lights.
Working range:	<15m (wireless control distance); <3m (PIR sensing distance).
Time delay	45 seconds preset.
Paring:	One Wireless Switch can pair with unlimited quantity of Wireless Receivers; One Wireless Receivers can pair with maximum 5 Wireless Switches (the same or different types of Wireless Switches).
Installation:	Recessed/Surface-mounted, optional
Waterproof rating (IP)	IP20
Dimensions:	49.5*46.7*12.8mm
Materials:	Plastic
Product color:	Customizable, black typ.
Operating temperature (C °)	-20~45 °C
Warranty period:	5 years

## VI. Installation

### 6.1 Recessed installation

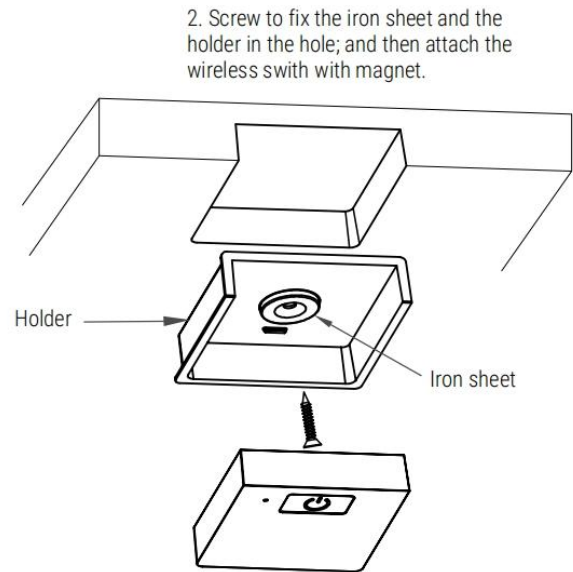
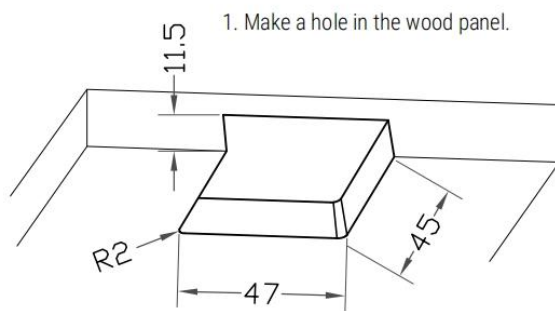

- (1) Prepare the Panel –  
Drill a hole in the wood panel according to the dimensions shown in the reference diagram.
- (2) Secure the Holder –  
Fix the iron sheet and the switch holder into the hole using screws.
- (3) Attach the Switch –  
Simply place the wireless switch onto the holder, where it will be securely held by magnets.

Now your wireless switch is ready to use!

### 6.2 Surface-mounted installation

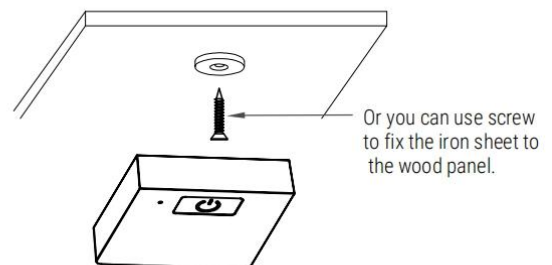
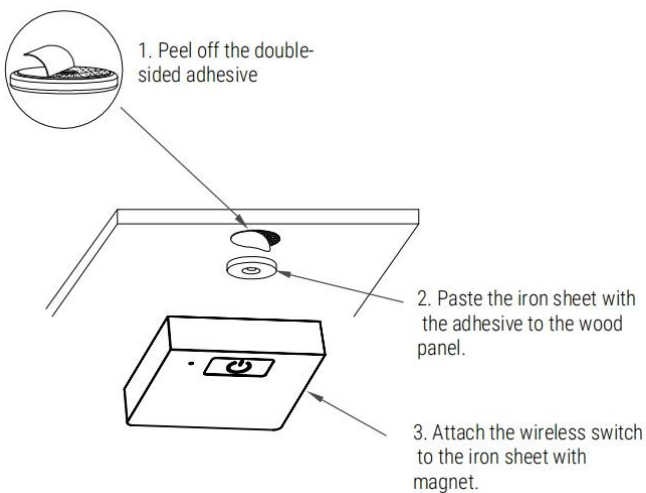

- (1) Prepare the Mounting Surface –  
Peel off the backing from the double-sided adhesive.
- (2) Fix the Iron Sheet –

Stick the iron sheet onto the wood panel using the adhesive, or secure it with screws for a stronger hold.

(3) Attach the Switch –

Place the wireless switch onto the iron sheet, where it will be held securely by magnets.

Your wireless switch is now installed and ready to use!

## VII. Usage

The Ariginal Wireless Switch is designed to enable seamless wireless control of LED lights. It works by pairing with an Ariginal Wireless Receiver, allowing users to turn lights on/off and adjust brightness effortlessly.

Its pairing options are flexible, One Receiver + One Switch, One Receiver + Up to 5 Switches, Multiple Receivers + One Switch or other combinations, with this high versatility, the Ariginal Wireless Switch adapts to various lighting setups, making it an ideal solution for customizable, wireless lighting control in homes, offices, and commercial spaces.

### 7.1 How to pair/unpair the Ariginal Wireless Receiver with Ariginal Wireless Switch

#### 7.1.1 Pair

Follow these simple steps to pair your Ariginal Wireless Receiver with an Ariginal Wireless Switch:

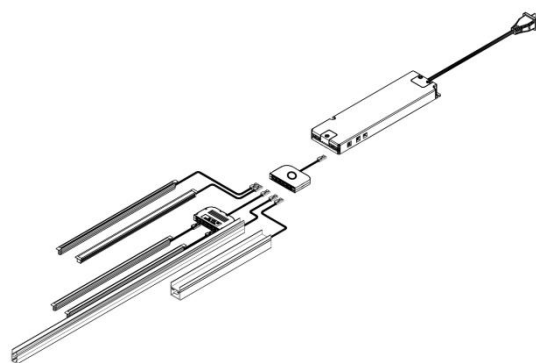

#### **1. Connect Power & Lights**

Insert the Wireless Receiver with DuPont connector into a power source (such as an LED driver). Connect the LED lights to the receiver's output ports.

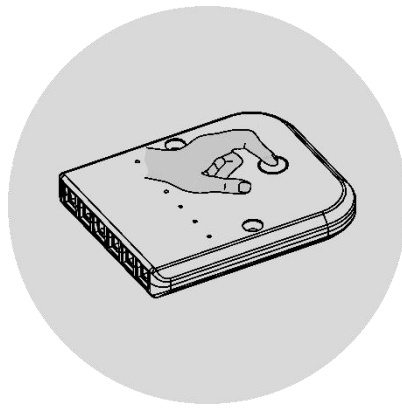

## 2. Press the Pairing Button on the Receiver

Locate the pairing button on the top of the receiver.  
Press it once to enter pairing mode.

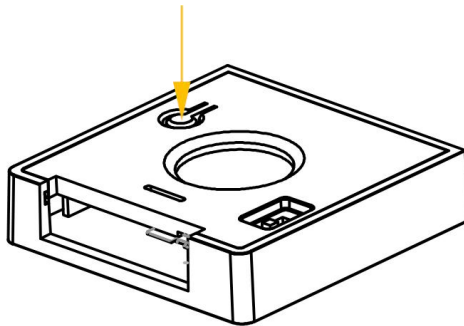

## 3. Press the Pairing Button on the Switch

Within 3 seconds, press the pairing button on the back of the Wireless Switch.

## 4. Confirm Pairing

If the pairing is successful, the lights will flash 3 times to indicate completion.  
Your Original Wireless Receiver and Wireless Switch are now paired and ready for use!

### 7.1.2 Unpair

There are two methods to unpair the receiver from the switch:

#### **Method 1: Unpair a Single Switch**

- (1) Power on the LED driver.
- (2) Press the pairing button on the receiver.
- (3) Within 3 seconds, press and hold the pair button on the back of the switch for 3 seconds.
- (4) The light will flash 3 times, indicating a successful unpairing.

#### **Method 2: Erase All Pairing Data**

- (1) Power on the LED driver.
- (2) Press and hold the pairing button on the receiver for over 3 seconds.
- (3) The light will flash 3 times, confirming that all paired switches have been erased.

Use Method 1 to remove a specific switch while keeping others paired, or Method 2 to reset the receiver and remove all paired switches at once.

## 7.2 How to use the Original Wireless Switch

### 7.2.1 One Receiver + One Switch

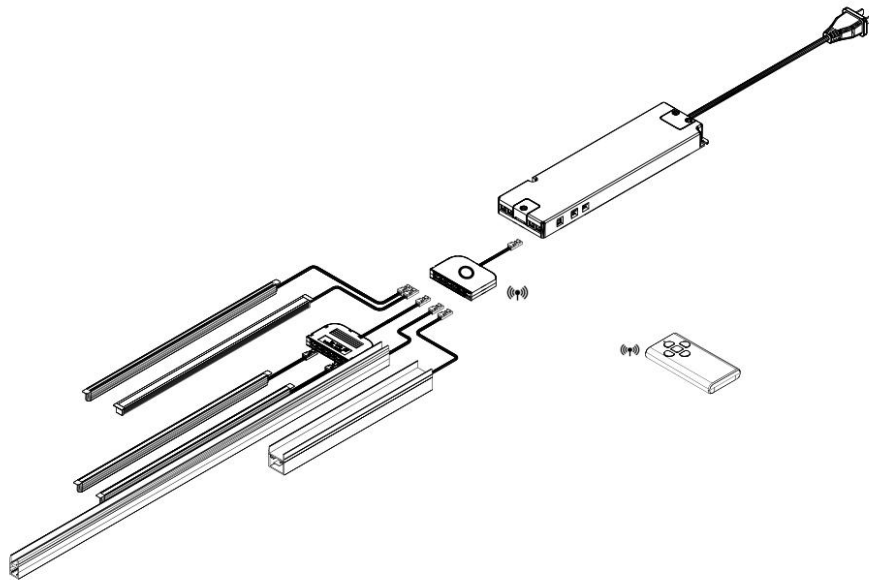

In this setup, one Original Wireless Receiver is paired with one Original Wireless Switch, creating a simple yet effective wireless lighting control system.

How It Works:

- Turn Lights On/Off – Press the wireless switch to toggle the connected LED lights on or off.
- Adjust Brightness – If using dimmable lights, long-press the switch to smoothly increase or decrease brightness.

This one-to-one pairing provides a straightforward and efficient wireless lighting solution for various indoor environments.

### 7.2.2 One Receiver + Up to 5 Switches

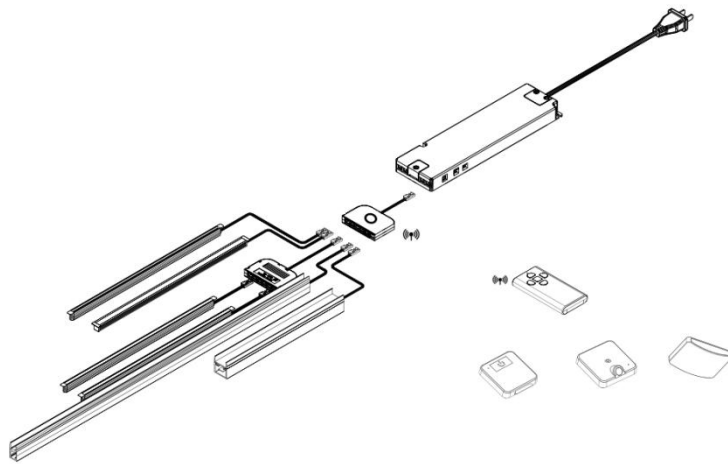

In this setup, one Ariginal Wireless Receiver can be paired with up to 5 different Ariginal Wireless Switches, allowing multiple control points for the same set of LED lights.

How It Works:

- Multi-Switch Control – Any of the paired switches can turn the connected lights on/off or adjust brightness (if dimmable).
- Mix & Match Switch Types – The 5 switches can be different types, offering various control methods based on convenience and application, such as IR / PIR / Door sensor / Touch sensor etc.

This one-to-multiple configuration provides seamless and versatile wireless lighting control, making it ideal for smart home setups, retail displays, and modern workspace lighting solutions.

### 7.2.3 Multiple Receivers + One Switch

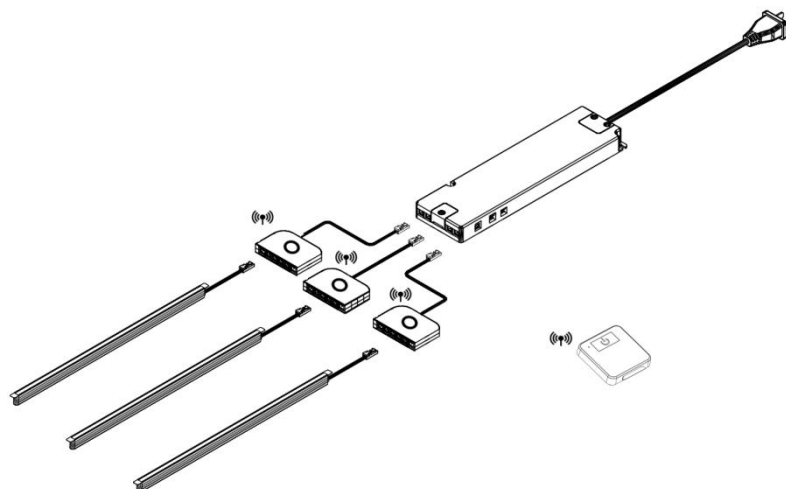

In this setup, one Ariginal Wireless Switch can be paired with an unlimited number of Ariginal Wireless Receivers, allowing it to control multiple sets of LED lights at the same time.

How It Works:

- Simultaneous Control – Pressing the wireless switch will turn on/off all paired receivers and their connected lights simultaneously. If dimmable lights are used, the switch can also adjust brightness for all lights at the same time.
- Unlimited Receivers – There is no limit to how many receivers can be paired with a single switch, making it highly scalable for different applications.
- Wide Coverage – Receivers can be placed in different areas, ensuring all lights are controlled synchronously with just one switch press.
- Easy Expansion – New receivers can be added anytime without affecting existing setups.

This one-to-many configuration offers seamless and unified wireless control, making it an efficient, flexible, and scalable solution for various lighting needs.

#### 7.2.4 Multiple Receivers + Multiple Switches

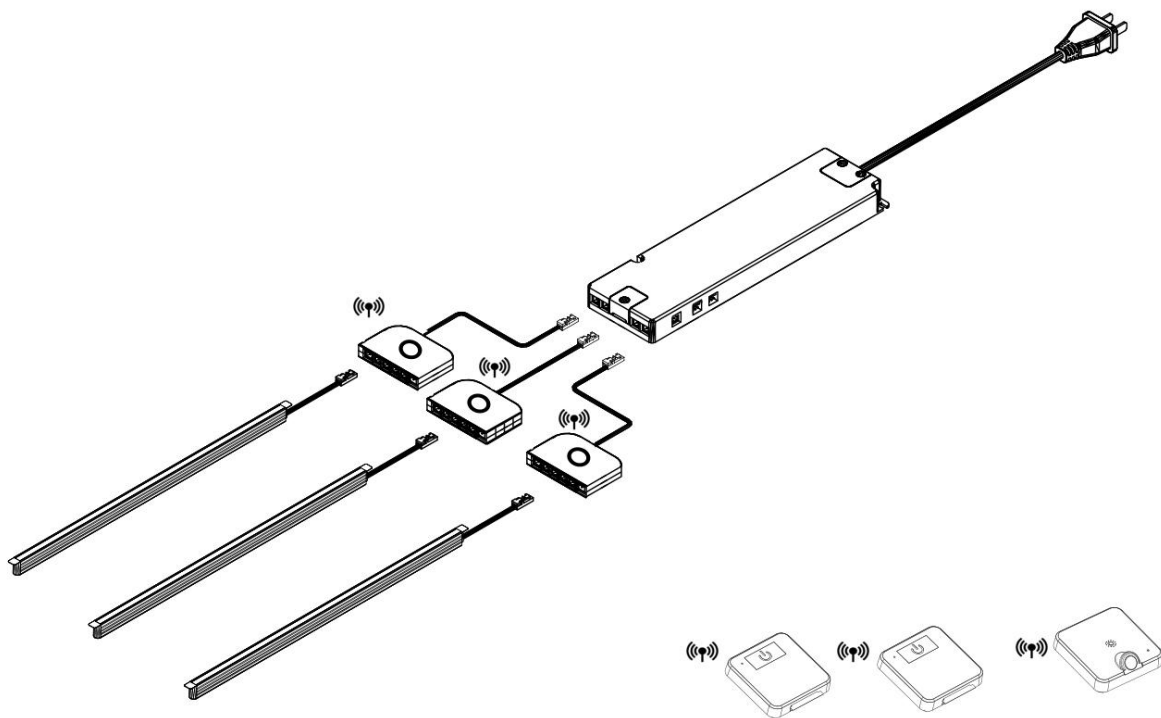

In this setup, multiple Ariginal Wireless Receivers are connected to the same LED driver, and each receiver is paired with one dedicated wireless switch. This allows each receiver to function as an independent control group.

How It Works:

- Separate Control Groups – Each receiver is paired with one wireless switch, meaning the lights connected to a particular receiver will only respond to its assigned switch.
- Multiple Independent Lighting Zones – Since multiple receivers are connected to the same LED driver, you can create multiple lighting zones, each controlled by its dedicated switch.
- Customizable Control Methods – Different types of wireless switches (e.g., PIR sensors, IR hand

swipe switches, door sensors, touch sensors) can be assigned to different receivers, allowing for diverse control methods in various areas.

In this setup, you can even use multiple Switches to control one specific Receiver if you need to control a group of lights from different locations.

This one-to-one pairing structure within a shared LED driver setup ensures organized, efficient, and customizable lighting control for various applications.



Shenzhen Ariginal Lighting Co., LTD.

M: +86 131 7246 1245

E: [info@ariginal.lighting](mailto:info@ariginal.lighting)

W: [ariginal.lighting](http://ariginal.lighting)